

Installation Tools for Thread-in Connector Series

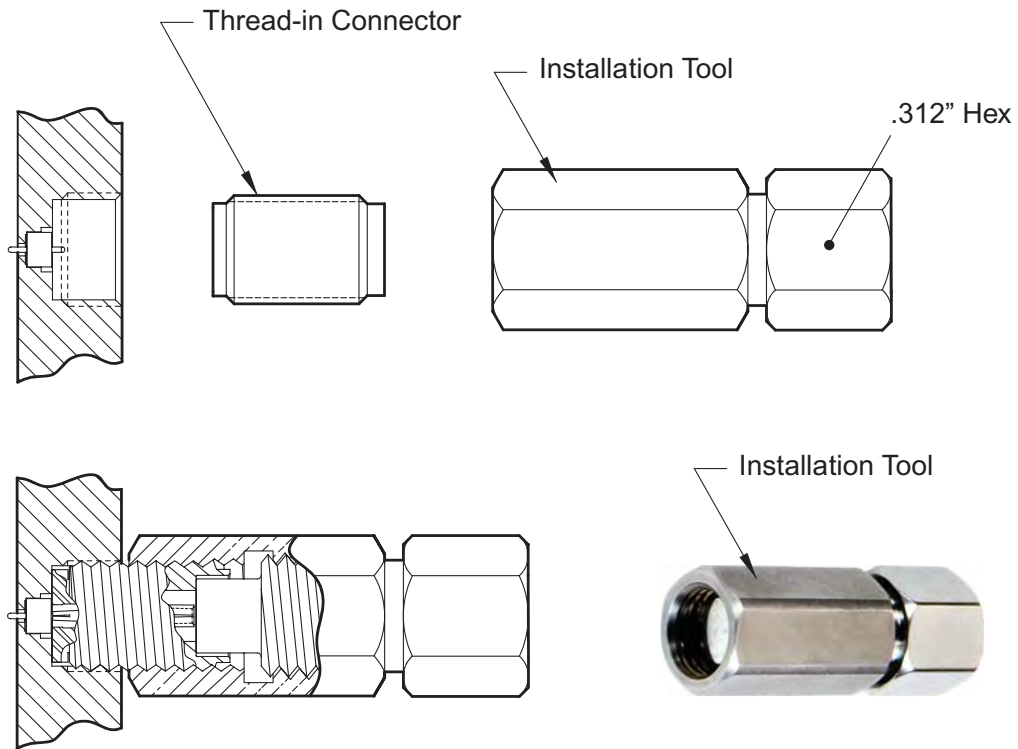

Tool No.	Thread-in Connector Series	Recommended Install Torque Nominal
T-1420-1	2.40 mm and 1.85 mm	18 in-lbs *
T-1020-1	2.92 mm, 3.5 mm and SMA	18 in-lbs *
T-120-1	SSMA	16 in-lbs *
T-53022-M2.5	0.9 mm	----

* Recommended mating connector coupling nut torque is about one half this amount.